

# WALL MOUNT

with DIN 14640 pivot pin

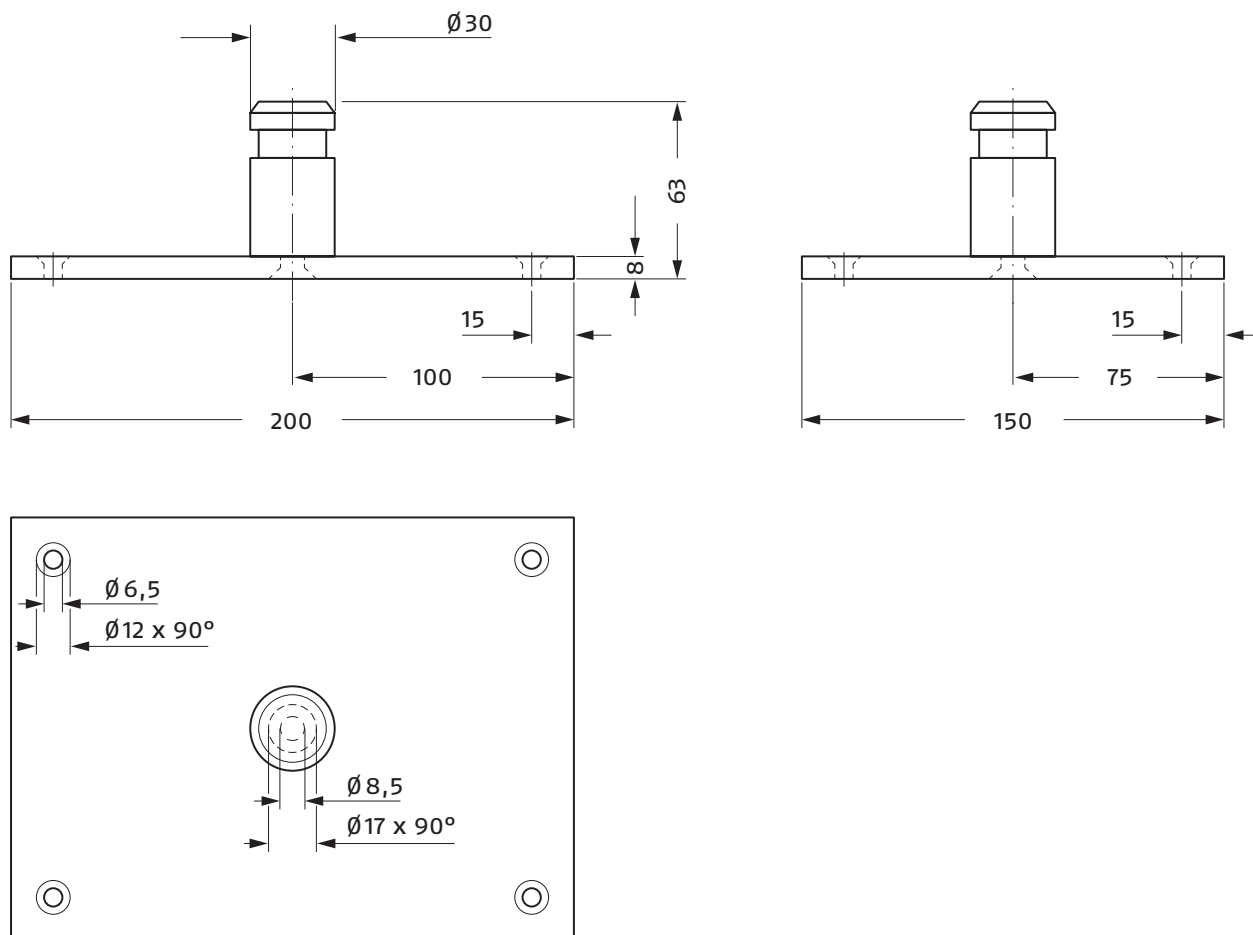

Dimensions	200 x 150 x 8 mm
Dead weight	0.75 kg
Material	Corrosion-proof aluminium
Mounting	Using 4 countersunk head screws Ø 6 mm, length depending on type of substrate (not included in the package).
Possible adjustments	Vertical and horizontal, locking by means of a star knob
Range of applications	The wall mount is particularly well suited for repetitive applications in which the lamp is supposed to be installed and removed quickly. A suitable mains outlet should be available.
Application examples	Buildings, cranes, construction machines, ski lifts, fairground rides, special events, etc.



KARL *Meister* GmbH